



## **KAPTI NUT®**

### **Saving with simplicity**

High strength captive nuts for sheet metal

**MeFaCo**  
INDUSTRIAL FASTENERS AND TOOLS

**BÖLLHOFF**

**KAPTI NUT®** – Captive Nuts

**KAPTI NUT®**



Supersedes: • Traditional weld nuts



KAPTI NUT® is a high strength, captive, threaded fastener system. It allows a range of nuts to be permanently attached to a panel or component by a mechanical process. The system is ideally suited to multiple insertion into thin steel strip and sheet and may be used with aluminium and stainless steel.



**Costs reduction**

- Single stroke press operation
- Installed as part of the press process operation
- Reduced equipment cost
- Multiple setting in a single operation



**Technical features**

- Structural captive threaded fastener
- High mechanical resistance
- Compatible with 8.8 screw
- One side completely flush
- Assembly in coated materials
- The installation process creates no fumes nor heat
- Minimum electrical power consumption
- Environmentally friendly
- Manufactured in accordance with ISO/TS 16949:2009.



**Installation**

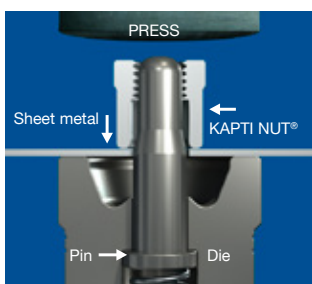

PHASE 1

Locate the KAPTI NUT® and the panel/component onto the tool pin.

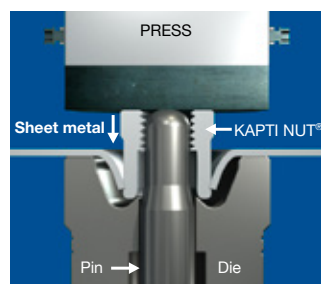

PHASE 2

Start the installation (pressing) process.

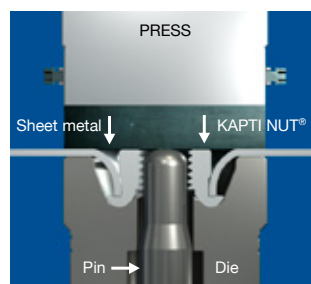

PHASE 3

The KAPTI NUT® uses the tool die to roll back the leading edge on itself to create the flange.

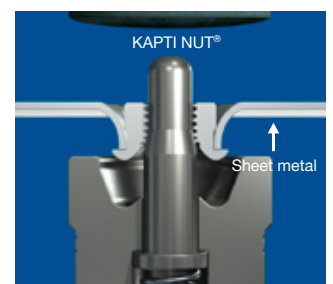

PHASE 4

The two parts are now locked providing a high strength threaded attachment point.

# KAPTI NUT® – Captive Nuts

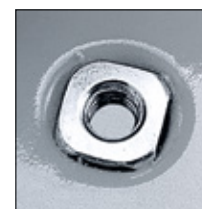

## Extra benefits compared to weld nuts:



Easy visual inspection



Full installation cost savings



Quick installation process



Suitable for pre-coated materials



Accurate positional control



High torque resistance



## Dimensions

Thread sizes conform to ISO metric coarse series 6H tolerance:

Our standard surface treatment for KAPTI NUT® is zinc trivalent (3-15 µm providing 400 hours to red rust) according to ISO 9227 specification.

THREAD SIZE	PANEL THICKNESS RANGE	ØA DIAMETER (mm)	H DIMENSION (mm)	PART NUMBER
M5	0,70 - 1,30	14.00	5.00 - 5.50	85100050011
M6	0,80 - 1,60	19.00	5.50 - 6.00	85100060011
M8	1 - 2	24.00	6.50 - 7.00	85100080011
M10	1,5 - 2,50	28.00	8.50 - 9.00	85100100011

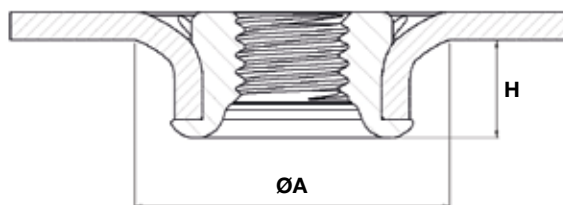

## Special Request

We can design specific features according to your application needs. A stud or pin version can be manufactured.

## Business field

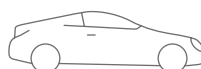

**Böllhoff International with companies in:**

Argentina  
Austria  
Brazil  
Canada  
China  
Czech Republic  
France  
Germany  
Hungary  
India  
Italy  
Japan  
Mexico  
Poland  
Romania  
Russia  
Slovakia  
South Korea  
Spain  
Switzerland  
Thailand  
Turkey  
United Kingdom  
USA

Apart from these 24 countries, Böllhoff supports its international customers in other important industrial markets in close partnership with agents and dealers.

**MeFaCo Intl. bvba**  
**Industrieweg 2, B-9200 Dendermonde Belgium**  
**Tel.: +32 (0)52 203923 Fax : +32 (0)52 219524**  
**Web: <https://www.mefaco-intl.com>**  
**E-mail: [info@mefaco-intl.com](mailto:info@mefaco-intl.com)**

